

UM Addendum Format

ADDENDUM #1

Page 1 of 1

TO CONTRACT DOCUMENTS ENTITLED: Project #CP241341 Various Locations – FY24 Summer Paving Project – Asphalt

ADVERTISEMENT DATE: March 25, 2024

PREPARED FOR: The Curators of the University of Missouri

CONSULTANT: MECO Engineering Co., Inc.
2701 Industrial Drive, Jefferson City, MO 65109
573-893-5558
Project Number 473-070

The contract documents for the above noted project and the work covered thereby and herein modified.

PROJECT MANUAL:

- 1) Add Section 1.H Alternates to the Table of Contents.
- 2) Section 1.A Bid for Lump Sum Contract, shall be deleted in its entirety and replaced by the attached Section 1.A Bid for Lump Sum Contract noted “Addendum 1” in the top right corner. Changes due to the University of Missouri having added Alternate Bid No. 1 Lot SG4/M into the proposal.
- 3) Add to Section 1.E Special Conditions, 3. Scope of Work, c. General Description of Work: Project consists of, (2) Alternate Bid added:
 - (g) SG4/M: The design includes mill and wedge repair for alligator cracking. Replacement of subgrade failures. Crack fill, edge mill and overlay the entire lot. The lot will be re-striped.
- 4) Add Section 1.F Index of Drawings: The index of sheets has additional sheets representing the Alternate Bid: Sheet No. 15: Alternate Bid No. 1, SG4/M Sign Location and Traffic Control; Sheet No. 16 and 17: Alternate Bid No. 1, SG4/M Repair Plan; and Sheet No. 18 and 19: Alternate Bid No. 1, SG4/M Striping Plan
- 5) Section 1.H Alternative Bid Section has been added, including Alternate Bid No. 1 Lot SG4/M.

PLANS:

- 1) Sheet No. 1 Cover Sheet: Change the Drawing Index to include:
Sheet 15: Alternate Bid No. 1, SG4/M Sign Location and Traffic Control
Sheet 16 and 17: Alternate Bid No. 1, SG4/M Repair Plan
Sheet 18-19: Alternate Bid No. 1, SG4/M Striping Plan
- 2) Add Sheets 15-19, marked Alternate Bid No. 1, to the Plan Set.
- 3) Sheet No. 3 Sign Location and Traffic Control, Detail SG7/A and SG7/B remove the two movable barricades indicated on the drive to the tunnel.

4) Sheet No. 7 SG7/A Striping Plan

a) Delete Note 3 in its entirety and replace it with the following:

3. Contractor shall replace all ADA signs and poles. The signs shall be installed at the correct height and in accordance with ADA requirements. The Contractor shall reuse the "Enforced 24 Hour" signs.

b) Add Note 4 to the Plan Sheet as follows:

4. Contractor shall remove, store and replace the "Team Store Parking" signs. Contractor shall provide new poles for the signs.

5) Sheet No. 9 SG7/B Striping Plan

a) Add Note 2 to the Plan Sheet

2. Contractor shall replace all ADA signs and poles, the signs shall be installed at the correct height and in accordance with ADA requirements.

b) Remove the ADA striping shown on the plan sheet and replace it with the ADA striping detail attached.

6) Sheet 10 SG5/S Repair Plan and Striping Plan

a) Add Note 8 to the Plan Sheet

8. Contractor shall replace all ADA signs and poles, the signs shall be installed at the correct height and in accordance with ADA requirements.

7) Sheet 11 SG5/K Repair Plan and Striping Plan

a) Remove Note 8 in its entirety and replace with the following:

8. Contractor shall replace all ADA signs and poles, the signs shall be installed at the correct height and in accordance with ADA requirements.

8) Sheet 13 SG4/O Striping Plan

a) Remove Note 2 in its entirety and replace with the following:

2. Contractor shall replace all ADA signs and poles. The signs shall be installed at the correct height and in accordance with ADA requirements.

9) Sheet 14 Typical Sections and Details

a) Add the attached new ADA sign detail to the sheet



END OF ADDENDUM #1

SECTION 1.A
BID FOR LUMP SUM CONTRACT

Date: _____

BID OF _____
(hereinafter called "Bidder") a corporation* organized and existing under laws of the State of _____
_____,
a partnership* consisting of _____,
an individual* trading as _____,
a joint venture* consisting of _____.

*Insert Corporation(s), partnership or individual, as applicable.

TO: Curators of the University of Missouri
C/O Assistant Vice Chancellor – Facilities
Room L100 – General Services Building
University of Missouri
Columbia MO 65211

1. Bidder, in compliance with invitation for bids for construction work in accordance with Drawings and Specifications prepared by MECO ENGINEERING COMPANY, INC., entitled CP241341 – VARIOUS LOCATIONS – FY24 SUMMER PAVING PROJECT – ASPHALT project number CP241341 dated March 25, 2024 having examined Contract Documents and site of proposed work, and being familiar with all conditions pertaining to construction of proposed project, including availability of materials and labor, hereby proposes to furnish all labor, materials and supplies to construct project in accordance with Contract Documents, within time set forth herein at prices stated below. Prices shall cover all expenses, including taxes not covered by the University of Missouri’s tax exemption status, incurred in performing work required under Contract documents, of which this Bid is a part.

Bidder acknowledges receipt of following addenda:

Addendum No. _____ Dated _____
Addendum No. _____ Dated _____
Addendum No. _____ Dated _____
Addendum No. _____ Dated _____

2. In following Bid(s), amount(s) shall be written in both words and figures. In case of discrepancy between words and figures, words shall govern.

3. BID PRICING

a. Base Bid:

The Bidder agrees to furnish all labor, materials, tools, and equipment required to construct VARIOUS LOCATIONS – FY24 SUMMER PAVING PROJECT – ASPHALT all as indicated on the Drawings and described in these Specifications for sum of:

_____ DOLLARS (\$_____).

b. Additive Alternate Bids:

Above Base Bid may be changed in accordance with following Alternate Bids as Owner may elect. Alternates are as described in Section 1.H of Project Manual. Alternates are written in a priority order, but Owner is not required to accept or reject in order listed. This is a one (1) contract project, therefore, Alternates shall be studied by each Bidder

to determine effect on Bids of Contractor and each Subcontractor and/or Material supplier.

- (1) Additive Alternate No. 1: Lot SG4/M The Contractor shall provide mill and wedge repair for alligator cracking, replacement of subgrade failures, crack fill, edge mill and overlay the entire lot with re-striping. All for the sum of:

_____ DOLLARS
 (\$_____).

b. Unit Prices:

(1) For changing specified quantities of work from those indicated by Contract Drawings and Specifications, upon written instructions of Owner, the following Unit Prices shall prevail in accordance with General Conditions.

(2) The following Unit Prices include all labor, overhead and profit, materials, equipment, appliances, bailing, shoring, shoring removal, etc., to cover all work.

(3) The following Unit Prices are required where applicable to particular Base Bid being submitted.

(4) Only a single Unit Price shall be given, and it shall apply for either MORE or LESS work than that indicated on Drawings and called for in Specifications as indicated to be included in Base Bid. In the event that more or less units than so indicated is actually furnished, Change Orders will be issued for increased or decreased amounts as approved by the Owner.

(5) Bidder understands that the Owner will not be liable for any Unit Price or any amount in excess of Base Bid accepted at time of award of Contract, except as expressed in written Change Orders duly executed and delivered by Owner's Representative.

(6) These quantities, at the specified unit price are included in the Contractor's Base Bid Price. If not used, the cost will be deducted by Change Order.

- (a) Pavement Patch Type 1
Base Bid Quantity = 351 square yd. \$_____/SY
- (b) Pavement Patch Type 2
Base Bid Quantity = 5,465 square yd. \$_____/SY
- (c) Pavement Patch Type 3
Base Bid Quantity = 1,260 square yd. \$_____/SY
- (d) Unsuitable Material Removal with Rock Replacement
Base Bid Quantity = 55 cubic yd. \$_____/CY

4. PROJECT COMPLETION

a. Contract Period - Contract period begins on the day the Contractor receives unsigned Contract, Performance Bond, Payment Bond, and "Instructions for Execution of Contract, Bonds, and Insurance Certificates." Bidder agrees to complete project within ninety (90) calendar days from receipt of aforementioned documents. Fifteen (15) calendar days have been allocated in construction schedule for receiving aforementioned documents from Bidder.

b. Commencement - Contractor agrees to commence work on this project after the "Notice to Proceed" is issued by the Owner. "Notice to Proceed" will be issued within seven (7) calendar days after Owner receives properly prepared and executed Contract documents listed in paragraph 4.a. above.

c. Special Scheduling Requirements: The Contractor shall schedule construction to minimize disruption of the following scheduled university events. Scheduling shall comply with the requirements in the contract special conditions.

- (1) 2024 Commencement May 10, 2024 – May 12, 2024
- (2) Columbia Public Schools Graduation May 23, 2024 – May 24, 2024
- (3) Senior Show Me State Games June 6, 2024 – June 9, 2024
- (4) Show Me State Games July 19, 2024 – July 21, 2024
July 26, 2024 – July 28, 2024

5. SUBCONTRACTOR LIST

Bidder hereby certifies that the following subcontractors will be used in performance of Work:
NOTE: Failure to list subcontractors for each category of work identified on this form or listing more than one subcontractor for any category of work without designating the portion of work performed by each shall be grounds for rejection of bid. List name, city, and state of designated subcontractor, for each category of work listed in Bid for Lump Sum Contract. If work within a category will be performed by more than one subcontractor, Bidder shall provide name, city, and state of each subcontractor and specify exact portion of work to be performed by each. If acceptance/non-acceptance of Alternates will affect designation of a subcontractor, Bidder shall provide information, for each affected category, with this bid form. If Bidder intends to perform any designated subcontract work by using Bidder's own employees, then Bidder shall list their own name, city, and state. The bidder may petition the Owner to change a listed subcontractor only within 48 hours of the bid opening. See Information for Bidders Section 16 List of Subcontractors for requirements.

Work to be performed	Subcontractor Name,	City, State
----------------------	---------------------	-------------

Painting _____

6. SUPPLIER DIVERSITY PARTICIPATION GOALS

a. The Contractor shall have as a goal, subcontracting with Minority Business Enterprise (MBE) of Ten Percent (10%), with Service Disabled Veteran Owned Business (SDVE) of three percent (3%); and with Women Business Enterprise (WBE), Disadvantage Business Enterprise (DBE), and/or Veteran Owned Business of Ten Percent (10%) of awarded contract price for work to be performed.

b. Requests for waiver of this goal shall be submitted on the attached Application for Waiver form. A determination by the UM Director of Facilities Planning & Development, that a good faith effort has not been made by Contractor to achieve above stated goal may result in rejection of bid.

c. The Undersigned proposes to perform work with following Supplier Diversity participation level:

MBE PERCENTAGE PARTICIPATION _____ PERCENT (_____ %)
SDVE PERCENTAGE PARTICIPATION _____ PERCENT (_____ %)

WBE, DBE, and/or VETERAN PERCENTAGE PARTICIPATION _____ PERCENT (____%)

d. A Supplier Diversity Compliance Evaluation form shall be submitted with this bid for each diverse subcontractor to be used on this project.

7. BIDDER'S ACKNOWLEDGMENTS

a. Bidder declares that he has had an opportunity to examine the site of the work and he has examined Contract Documents; therefore, that he has carefully prepared his bid upon the basis thereof; that he has carefully examined and checked bid, materials, equipment and labor required thereunder, cost thereof, and his figures therefore. Bidder hereby states that amount, or amounts, set forth in bid is, or are, correct and that no mistake or error has occurred in bid or in Bidder's computations upon which this bid is based. Bidder agrees that he will make no claim for reformation, modifications, revisions or correction of bid after scheduled closing time for receipt of bids.

b. Bidder agrees that bid shall not be withdrawn for a period of sixty (60) days after scheduled closing time for receipt of bids.

c. Bidder understands that Owner reserves right to reject any or all bids and to waive any informalities in bidding.

d. Accompanying the bid is a bid bond, or a certified check, or an irrevocable letter of credit, or a cashier's check payable without condition to "The Curators of the University of Missouri" which is an amount at least equal to five percent (5%) of amount of largest possible total bid herein submitted, including consideration of Alternates.

e. Accompanying the bid is a Bidder's Statement of Qualifications. Failure of Bidder to submit the Bidder's Statement of Qualifications with the bid may cause the bid to be rejected. Owner does not maintain Bidder's Statements of Qualifications on file.

f. It is understood and agreed that bid security of two (2) lowest and responsive Bidders will be retained until Contract has been executed and an acceptable Performance Bond and Payment Bond has been furnished. It is understood and agreed that if the bid is accepted and the undersigned fails to execute the Contract and furnish acceptable Performance/Payment Bond as required by Contract Documents, accompanying bid security will be realized upon or retained by Owner. Otherwise, the bid security will be returned to the undersigned.

8. BIDDER'S CERTIFICATE

Bidder hereby certifies:

a. His bid is genuine and is not made in interest of or on behalf of any undisclosed person, firm or corporation, and is not submitted in conformity with any agreement or rules of any group, association or corporation.

b. He has not directly or indirectly induced or solicited any other bidder to put in a false or sham bid.

c. He has not solicited or induced any person, firm or corporation to refrain from bidding.

d. He has not sought by collusion or otherwise to obtain for himself any advantage over any other Bidder or over Owner.

e. He will not discriminate against any employee or applicant for employment because of race, color, religion, sex or national origin in connection with performance of work.

f. By virtue of policy of the Board of Curators, and by virtue of statutory authority, a preference will be given to materials, products, supplies, provisions and all other articles produced, manufactured, mined or grown within the State of Missouri. By virtue of policy of the Board of Curators, preference will also be given to all Missouri firms, corporations, or individuals, all as more fully set forth in "Information For Bidders."

9. BIDDER'S SIGNATURE

Note: All signatures shall be original; not copies, photocopies, stamped, etc.

Authorized Signature	Date
Printed Name	Title
Company Name 1.	
Mailing Address 2.	
City, State, Zip 3.	
Phone No.	Federal Employer ID No.
Fax No.	E-Mail Address
Circle one: Individual Partnership Corporation Joint Venture	
If a corporation, incorporated under the laws of the State of _____	
Licensed to do business in the State of Missouri? ___yes ___no	

(Each Bidder shall complete bid form by manually signing on the proper signature line above and supplying required information called for in connection with the signature. Information is necessary for proper preparation of the Contract, Performance Bond and Payment Bond. Each Bidder shall supply information called for in accompanying "Bidder's Statement of Qualifications.")

END OF SECTION

SECTION 1.F

INDEX OF DRAWINGS

Drawings referred to in and accompanying Project Manual consist of following sheets dated March 25, 2024.

CP241341 - VARIOUS LOCATIONS – FY24 SUMMER PAVING PROJECT ASPHALT

Sheet 1 of 19:	Cover Sheet / Project Location
Sheet 2 of 19:	Standard Notes
Sheet 3 of 19:	Sign Location and Traffic Control
Sheet 4 and 5 of 19:	SG7/A Repair Plan
Sheet 6 and 7 of 19:	SG7/A Striping Plan
Sheet 8 of 19:	SG7/B Repair Plan
Sheet 9 of 19:	SG7/B Striping Plan
Sheet 10 of 19:	SG5/J Repair Plan / Striping Plan
Sheet 11 of 19:	SG5/K Repair Plan / Striping Plan
Sheet 12 of 19:	SG4/O Repair Plan
Sheet 13 of 19:	SG4/O Striping Plan
Sheet 14 of 19:	Typical Sections and Details
Sheet 15 of 19:	Alternate Bid No. 1 SG4/M Sign Location and Traffic Control
Sheet 16 and 17 of 19:	Alternate Bid No. 1 SG4/M Repair Plan
Sheet 18 and 19 of 19:	Alternate Bid No. 1 SG4/M Striping Plan

END OF SECTION

SECTION 1.H

ALTERNATES

Base Bid may be increased in accordance with following Additive Alternate proposal(s) as Owner may elect:

1. Additive Alternate No. 1: Lot SG4/M

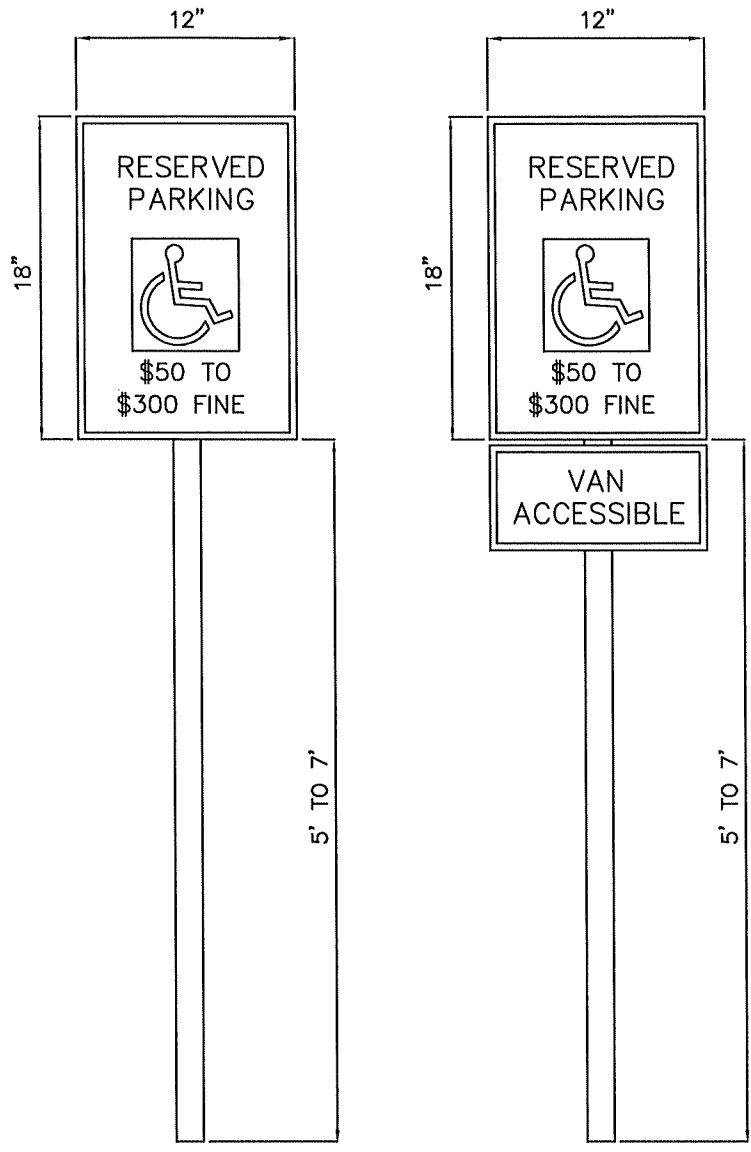

ADA PARKING SIGN

L:\400-Projects\473-070 UMC 2024 Summer Paving - Design\DRAWINGS\ASPHALT PACKAGE\SG7AB-A ADDEN.dwg, SG7B STRIPE ADDENDUM, 4/3/2024 12:12:06 PM

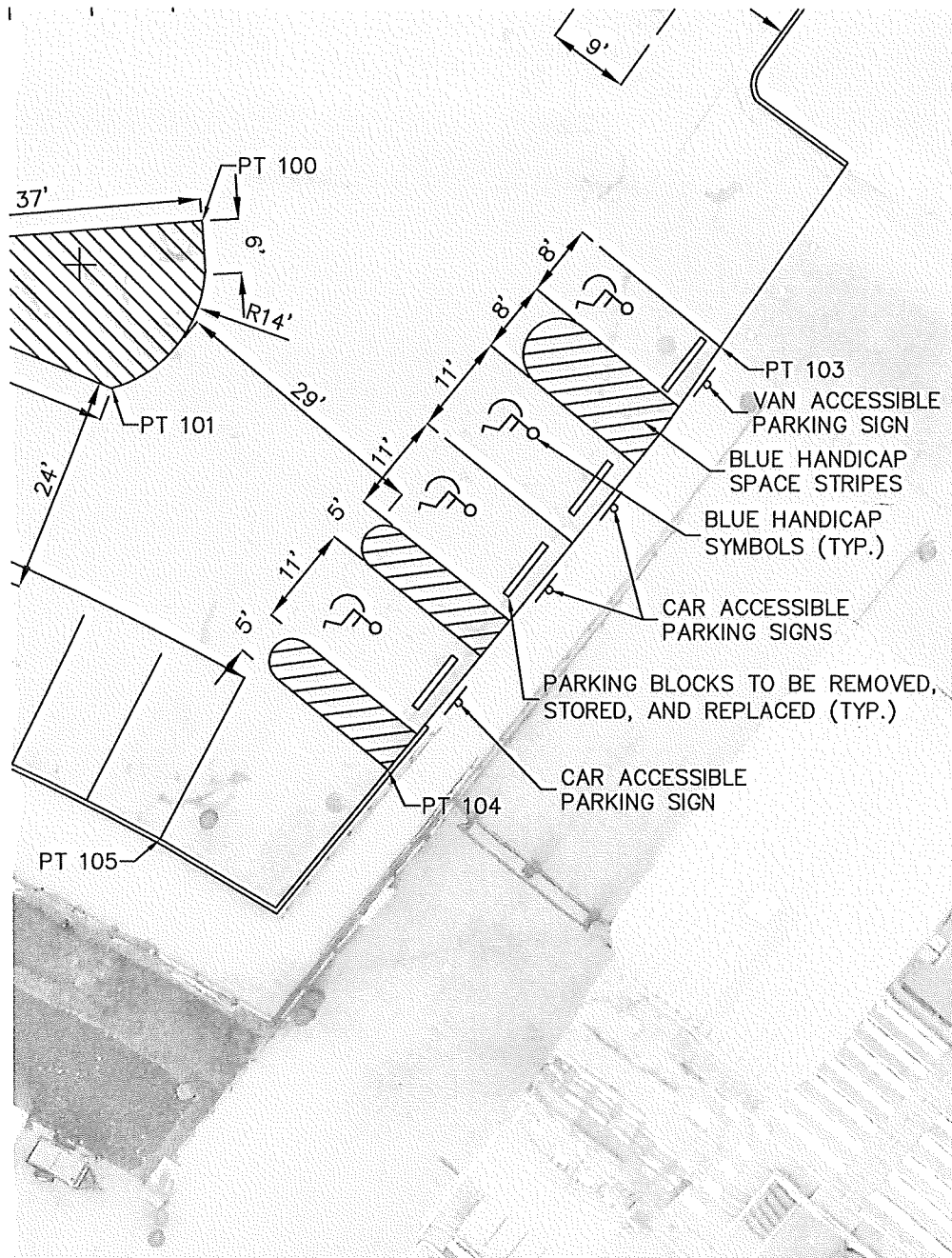

SG7B ADA STRIPING LAYOUT

ADDENDUM NO. 1
CP241341 FY24 SUMMER PAVING PROJECT - ASPHALT

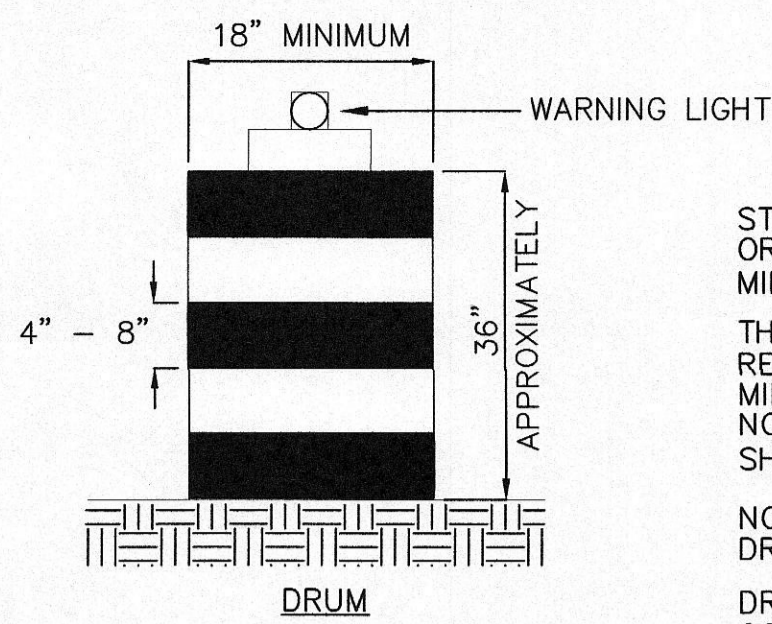

STRIPES SHALL BE ALTERNATING HORIZONTAL REFLECTIVE ORANGE (TWO MINIMUM) AND REFLECTIVE WHITE (TWO MINIMUM) TYPE 2 REFLECTIVE SHEETING.

THE CONTRACTOR HAS THE OPTION TO USE FLEXIBLE OR REBOUNDABLE REFLECTIVE SHEETING WITH THE SAME MINIMUM REQUIREMENTS AS TYPE 2 REFLECTIVE SHEETING. NON-REFLECTORIZED ORANGE SPACES BETWEEN STRIPES SHALL BE NO GREATER THAN TWO INCHES.

NO DIRECT PAYMENT WILL BE MADE FOR RELOCATION OF DRUMS OR CHANNELIZERS.

DRUMS OR CHANNELIZERS SHALL BE USED DURING CONSTRUCTION FOR THE PROTECTION OF VEHICULAR TRAFFIC OR AS DIRECTED BY THE ENGINEER.

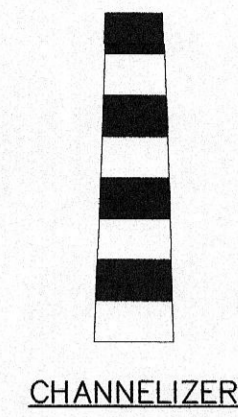

NOTES:

1. THE CONTRACTOR SHALL UTILIZE CONSTRUCTION SIGNS ONLY WHEN NECESSARY DUE TO CONSTRUCTION OPERATIONS. ALL SIGNS AND HANDLING OF TRAFFIC SHALL BE IN ACCORDANCE WITH MUTCD.
2. ALL SIGNS GREATER THAN 10 SQUARE FEET IN AREA SHALL BE MOUNTED ON TWO POSTS.
3. THE CONTRACTOR SHALL MODIFY THE TRAFFIC CONTROL PLAN TO FIT HIS CONSTRUCTION TECHNIQUE AND SCHEDULE. ANY MODIFIED TRAFFIC CONTROL PLAN SHALL BE APPROVED BY THE ENGINEER.
4. THE CONTRACTOR SHALL COORDINATE WITH THE OWNER'S REPRESENTATIVE AND PROVIDE ADEQUATE TRAFFIC CONTROL FOR ALL LOTS OR ROADS IN ACCORDANCE WITH MUTCD.

SIGN SUMMARY					
SIGN	SIZE INCHES	AREA SQ. FT.	QUANTITY	TOTAL AREA SQ. FT.	SIGN LEGEND
WARNING SIGNS					
① W20-1	48" X 48"	16.0	2	32	ROAD WORK AHEAD
CONSTRUCTION SIGNS				32	SQ. FT. TOTAL

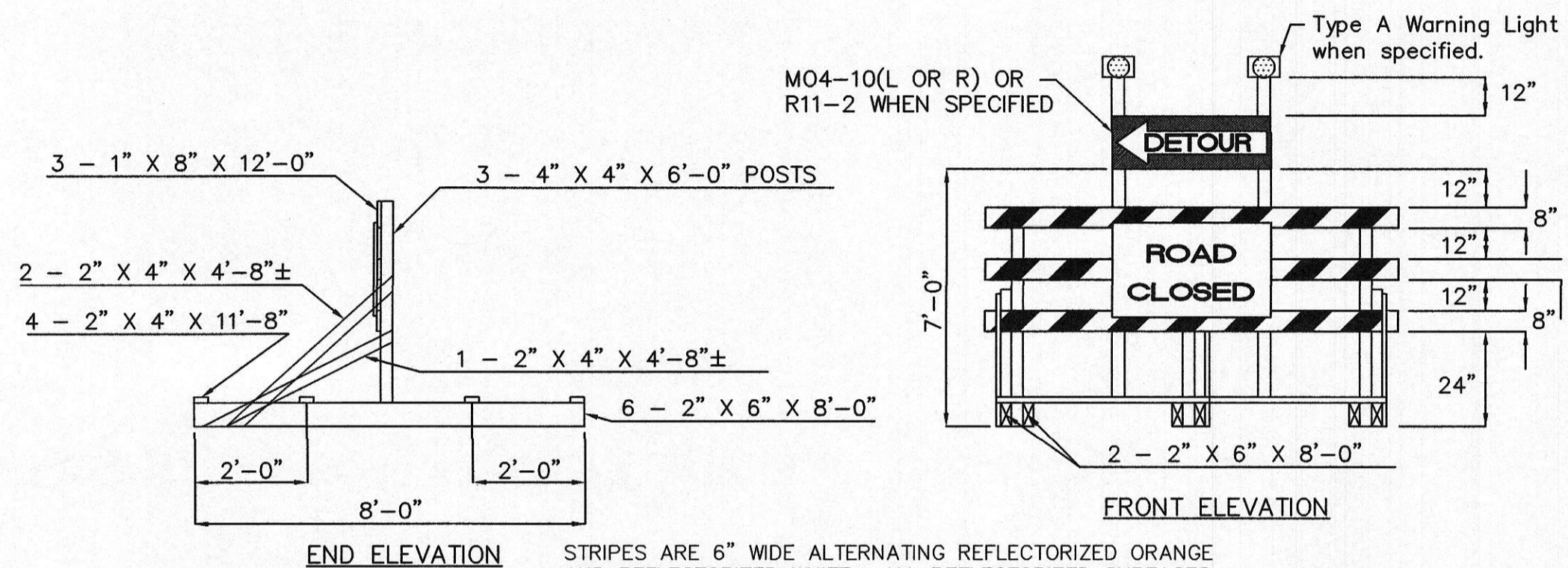

STRIPES ARE 6" WIDE ALTERNATING REFLECTORIZED ORANGE AND REFLECTORIZED WHITE. ALL REFLECTORIZED SURFACES SHALL BE TYPE 1 SHEETING. NO DIRECT PAYMENT WILL BE MADE FOR RELOCATION OF BARRICADES. STRIPES SHALL SLOPE DOWNWARD TOWARD THE SIDE TRAFFIC IS TO PASS.

TYPE III MOVABLE BARRICADE UNIT

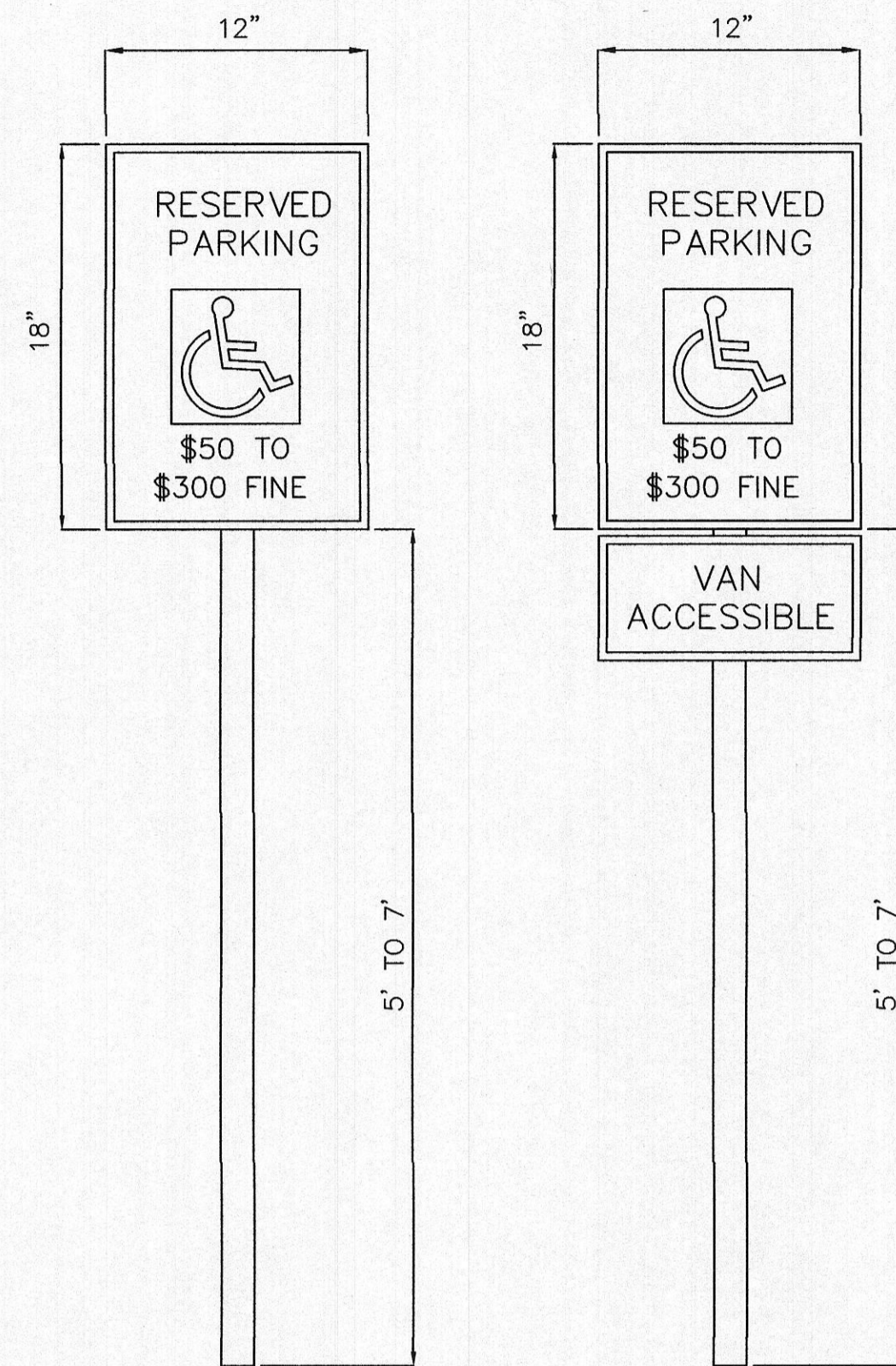

TYPICAL ADA HANDICAP PARKING SIGN DETAIL

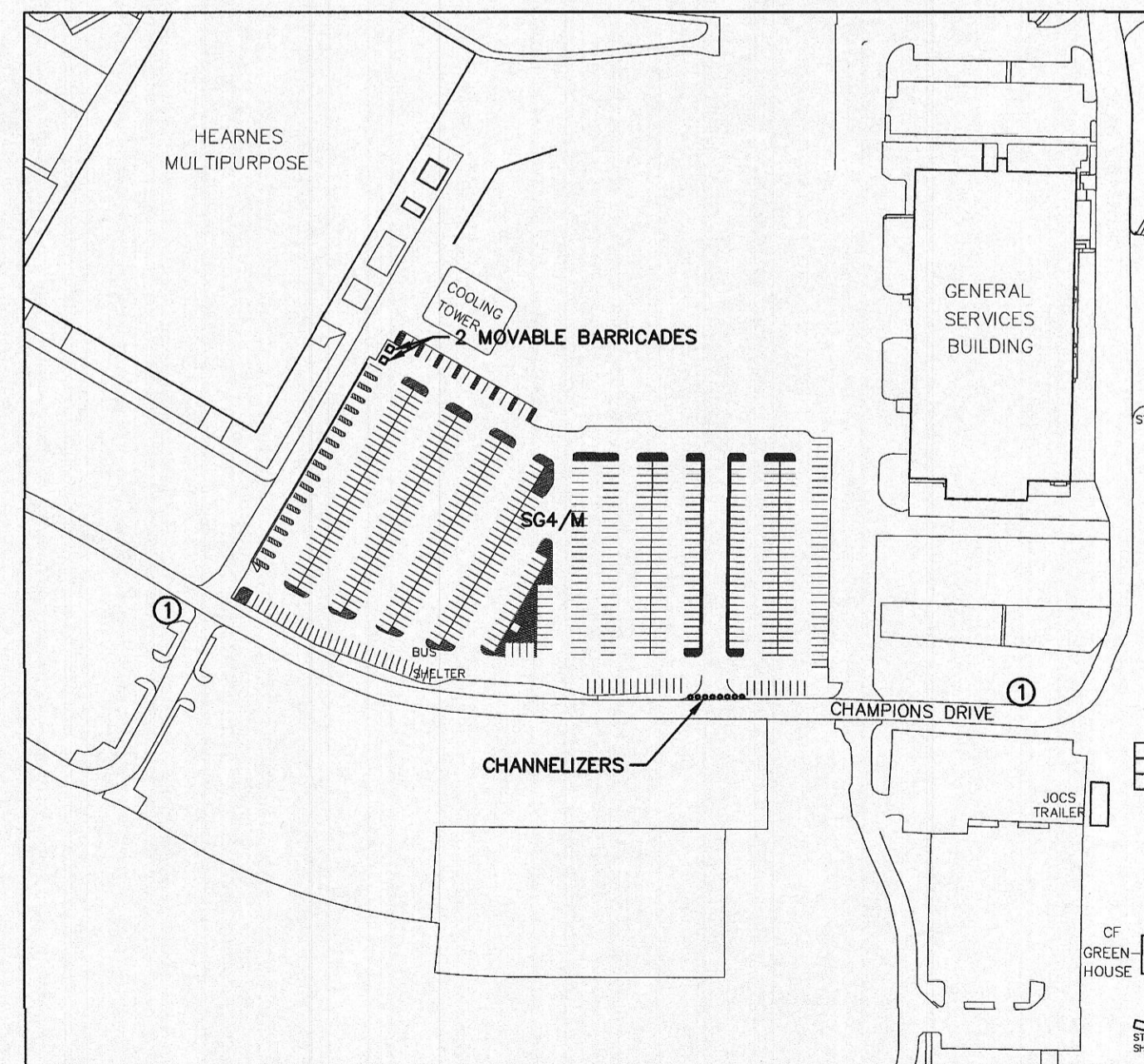

SG4/M REPAIRS (ALTERNATE BID NO. 1)

ADDENDUM NO. 1
 BID SET ISSUED: 03/25/2024

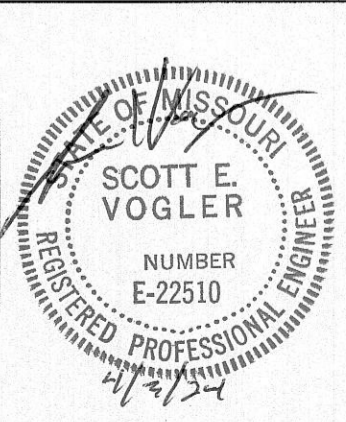

NO.	DATE	REVISION DESCRIPTION	BY

MECO
 ENGINEERING CO., INC.

OFFICE LOCATIONS
 HANIBAL, MO
 JEFFERSON CITY, MO
 BRANSON, MO
 BOONVILLE, MO
 PITTSFIELD, IL

mecoengineering.com
 MO Engineering Lic. #000898 - IL Design Firm #184-001749

THE PROFESSIONAL WHOSE SIGNATURE AND PERSONAL SEAL APPEARS ON THIS SHEET ASSUMES RESPONSIBILITY ONLY FOR WHAT APPEARS ON THIS PAGE, AND DISCLAIMS (PURSUANT TO SECTION 327.411 RSMO) & (PURSUANT TO 225 ILCS 325/PROFESSIONAL ENGINEERING PRACTICE ACT OF 1989) ANY RESPONSIBILITY FOR ALL OTHER PLANS, SPECIFICATIONS, ESTIMATES, REPORTS, OR OTHER DOCUMENTS OR INSTRUMENTS NOT SEALED BY THE UNDERSIGNED PROFESSIONAL RELATING TO OR INTENDED TO BE USED FOR ANY PART, OR PARTS OF THE PROJECT TO WHICH THIS PAGE REFERS.

VARIOUS LOCATIONS FY24 SUMMER PAVING PROJECT - ASPHALT UNIVERSITY OF MISSOURI PROJECT NO. CP241341					
SURVEYED	DESIGNED	DRAWN	CHECKED	APPROVED	RELEASED
	SEV	EW/TN			

ALTERNATE BID NO. 1 SG4/M SIGN LOCATION AND TRAFFIC CONTROL			
SCALE	DRAWING NAME	PROJECT NUMBER	SHEET NO.
	TrafControlSG4M-Adden	CP241341 473-070	15

L:\MO-Project\CP241341\03/25/2024\Summer Paving - Design\DRAWINGS\ASPHALT PACKAGE\TrafficControl\SG4M-Adden.dwg, 11/16/24, 2:28:55 PM

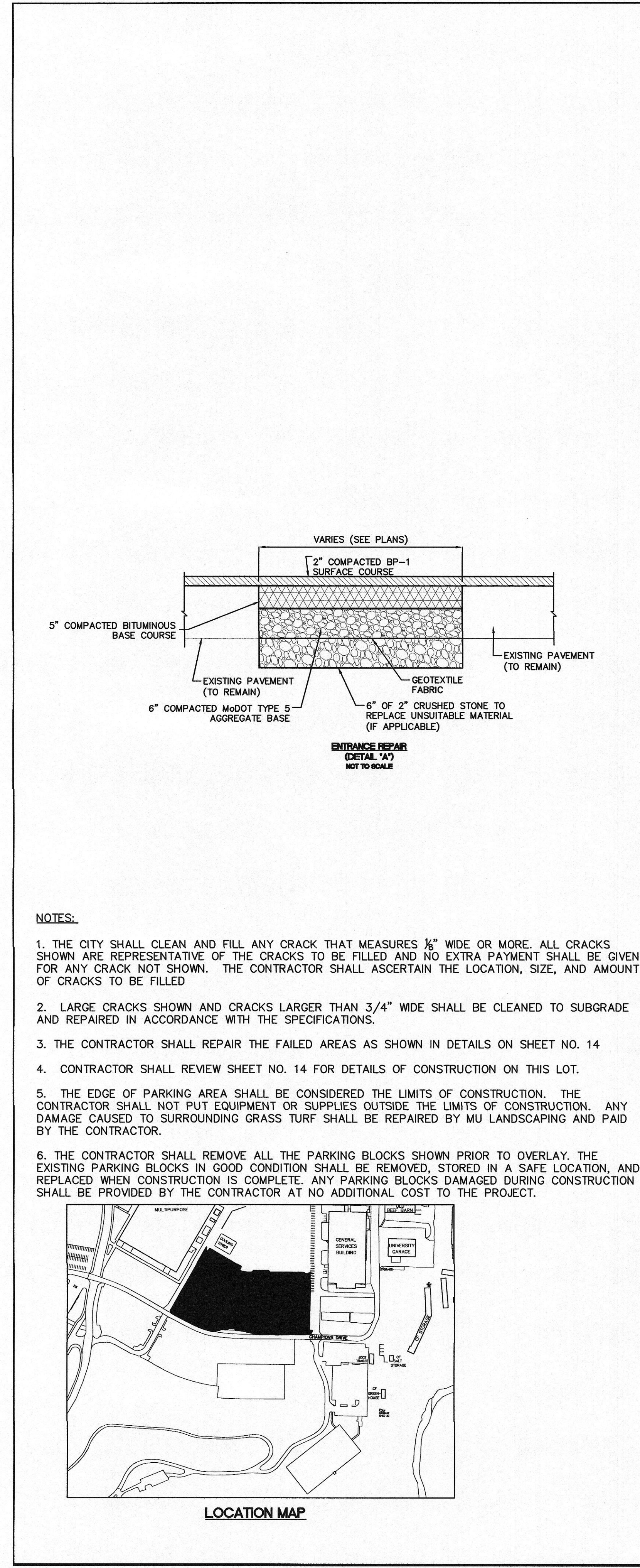

- NOTES:**
1. THE CITY SHALL CLEAN AND FILL ANY CRACK THAT MEASURES $\frac{1}{8}$ " WIDE OR MORE. ALL CRACKS SHOWN ARE REPRESENTATIVE OF THE CRACKS TO BE FILLED AND NO EXTRA PAYMENT SHALL BE GIVEN FOR ANY CRACK NOT SHOWN. THE CONTRACTOR SHALL ASCERTAIN THE LOCATION, SIZE, AND AMOUNT OF CRACKS TO BE FILLED.
 2. LARGE CRACKS SHOWN AND CRACKS LARGER THAN $\frac{3}{4}$ " WIDE SHALL BE CLEANED TO SUBGRADE AND REPAIRED IN ACCORDANCE WITH THE SPECIFICATIONS.
 3. THE CONTRACTOR SHALL REPAIR THE FAILED AREAS AS SHOWN IN DETAILS ON SHEET NO. 14
 4. CONTRACTOR SHALL REVIEW SHEET NO. 14 FOR DETAILS OF CONSTRUCTION ON THIS LOT.
 5. THE EDGE OF PARKING AREA SHALL BE CONSIDERED THE LIMITS OF CONSTRUCTION. THE CONTRACTOR SHALL NOT PUT EQUIPMENT OR SUPPLIES OUTSIDE THE LIMITS OF CONSTRUCTION. ANY DAMAGE CAUSED TO SURROUNDING GRASS TURF SHALL BE REPAIRED BY MU LANDSCAPING AND PAID BY THE CONTRACTOR.
 6. THE CONTRACTOR SHALL REMOVE ALL THE PARKING BLOCKS SHOWN PRIOR TO OVERLAY. THE EXISTING PARKING BLOCKS IN GOOD CONDITION SHALL BE REMOVED, STORED IN A SAFE LOCATION, AND REPLACED WHEN CONSTRUCTION IS COMPLETE. ANY PARKING BLOCKS DAMAGED DURING CONSTRUCTION SHALL BE PROVIDED BY THE CONTRACTOR AT NO ADDITIONAL COST TO THE PROJECT.

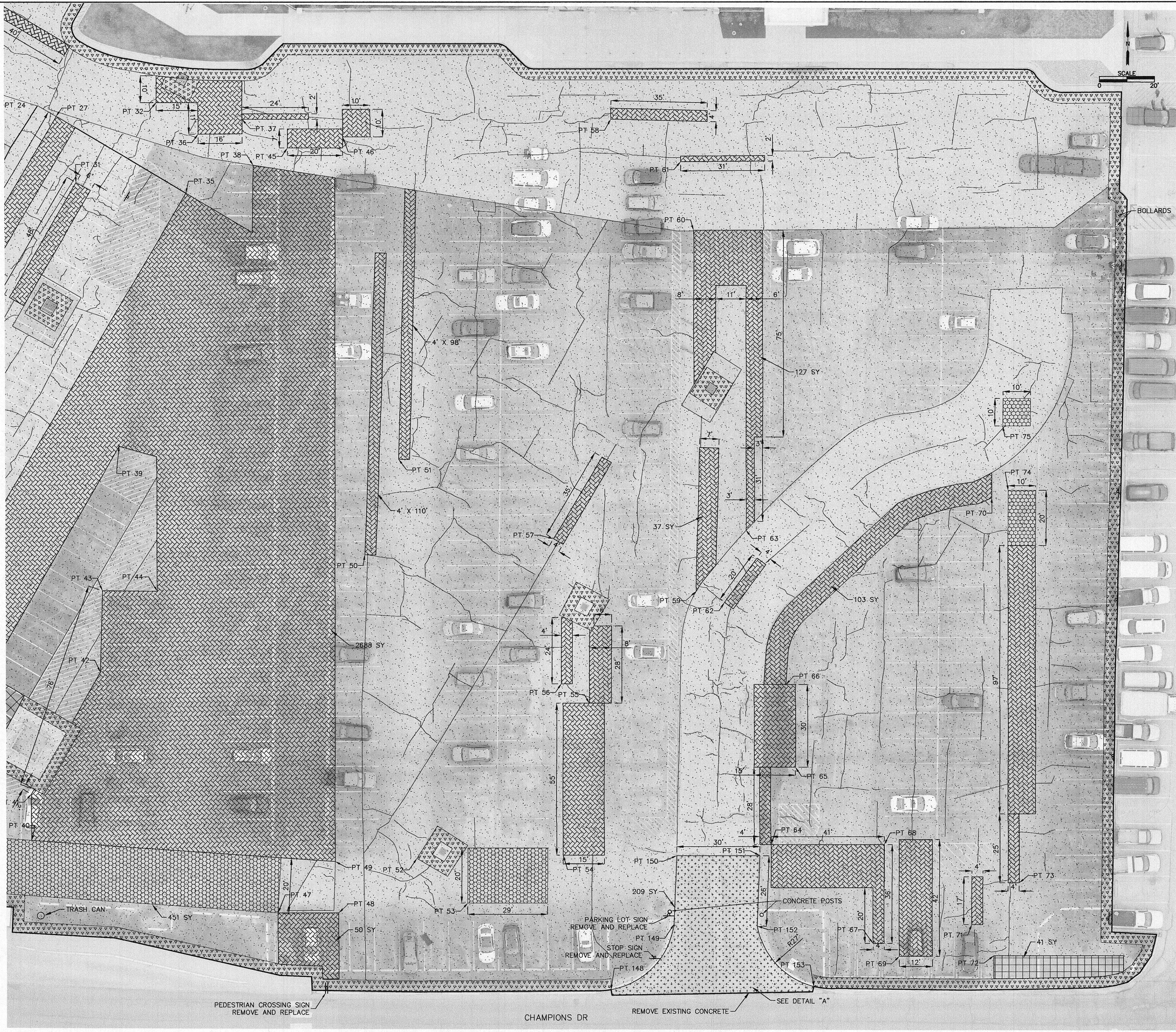
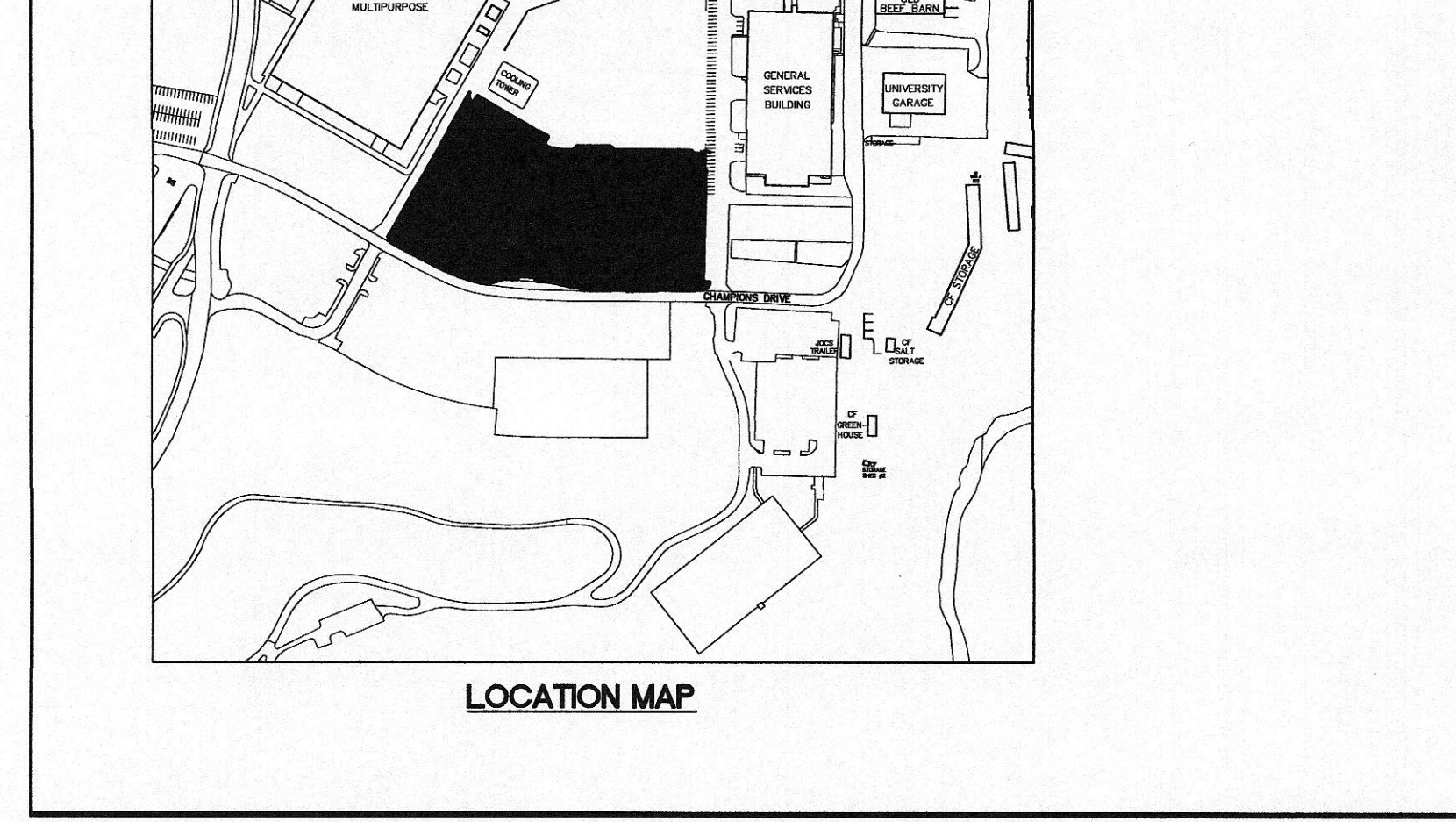

LEGEND:

- 2" BP-1 OVERLAY: [Pattern]
- 2" MILL AND WEDGE REPAIR: [Pattern]
- ENTRANCE REPAIR: [Pattern]
- 4" EDGE MILL: [Pattern]
- SUBGRADE REPAIR: [Pattern]
- MILL/OVERLAY TO ALLOW DRAINAGE: [Pattern]
- SMALL CRACK: [Symbol]
- LARGE CRACK: [Symbol]

Control Point Table

Point #	Northing	Easting	Description
46	1128752.14	1689058.55	REPAIR
47	1128470.90	1689035.11	REPAIR
48	1128470.90	1689057.11	REPAIR
49	1128489.52	1689055.74	REPAIR
50	1128600.61	1689066.65	REPAIR
51	1128635.28	1689078.91	REPAIR
52	1128490.65	1689085.43	REPAIR
53	1128474.42	1689103.92	EDGE MILL
54	1128491.80	1689148.14	REPAIR
55	1128546.80	1689148.14	REPAIR
56	1128553.86	1689137.95	REPAIR
57	1128606.38	1689135.14	REPAIR
58	1128758.48	1689155.97	REPAIR
59	1128587.34	1689186.88	REPAIR
60	1128718.26	1689186.11	REPAIR
61	1128743.10	1689181.30	REPAIR
62	1128583.30	1689197.13	REPAIR
63	1128609.42	1689205.11	REPAIR
64	1128495.59	1689214.08	REPAIR
65	1128523.59	1689222.94	REPAIR
66	1128553.59	1689219.52	REPAIR
67	1128459.73	1689251.06	REPAIR
68	1128495.59	1689255.12	REPAIR
69	1128455.05	1689260.53	REPAIR
70	1128621.18	1689294.24	REPAIR
71	1128466.54	1689286.98	REPAIR
72	1128455.23	1689294.90	REPAIR
73	1128481.66	1689304.16	REPAIR
74	1128623.82	1689300.16	REPAIR
75	1128647.23	1689298.34	REPAIR
148	1128442.94	1689155.90	REPAIR
149	1128466.74	1689178.88	REPAIR
150	1128491.61	1689179.78	REPAIR
151	1128491.59	1689209.94	REPAIR
152	1128466.04	1689209.07	REPAIR
153	1128444.12	1689229.49	REPAIR

NOTES TO THE CONTRACTOR:

Underground facilities, structures, and utilities have been plotted from available surveys and records and therefore, their locations must be considered approximate only. There may be others, the existence of which is at present not known. Verification of the locations of underground utilities, shown or not shown, will be the responsibility of the construction contractor. The contractor shall make suitable and timely requests to all utility owners, pipeline owners, or other parties affected to have all necessary adjustments of public or private utilities, pipe lines, or other appurtenances within, or adjacent to the limits of construction, as soon as practical or possible.

ADDENDUM NO. 1
BID SET ISSUED: 03/25/2024

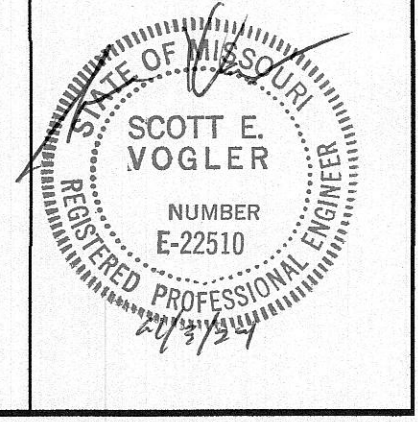

<p>IF THIS DRAWING IS PLOTTED LESS THAN 24x36 IN SIZE, IT IS A REDUCED PLOT - SCALE SHOULD BE ADJUSTED ACCORDINGLY.</p>	<p>MECO ENGINEERING CO., INC.</p> <p>moengineering.com MO Engineering Lic. #000898 - IL Design Firm #184-001749</p>	<p>OFFICE LOCATIONS HANNIBAL, MO JEFFERSON CITY, MO BRANSON, MO BOONVILLE, MO PITTSFIELD, IL</p>	<p>THE PROFESSIONAL WHOSE SIGNATURE AND PERSONAL SEAL APPEARS ON THIS SHEET ASSUMES RESPONSIBILITY ONLY FOR WHAT APPEARS ON THIS PAGE, AND DISCLAIMS (PURSUANT TO SECTION 327.411 RSMO) & (PURSUANT TO 225 ILCS 325/PROFESSIONAL ENGINEERING PRACTICE ACT OF 1989) ANY RESPONSIBILITY FOR ALL OTHER PLANS, SPECIFICATIONS, ESTIMATES, REPORTS, OR OTHER DOCUMENTS OR INSTRUMENTS NOT SEALED BY THE UNDERSIGNED PROFESSIONAL RELATING TO OR INTENDED TO BE USED FOR ANY PART, OR PARTS OF THE PROJECT TO WHICH THIS PAGE REFERS.</p>	<p>VARIOUS LOCATIONS FY24 SUMMER PAVING PROJECT - ASPHALT UNIVERSITY OF MISSOURI PROJECT NO. CP241341</p> <table border="1" style="width:100%; border-collapse: collapse;"> <tr> <td>SURVEYED</td> <td>DESIGNED</td> <td>DRAWN</td> <td>CHECKED</td> <td>APPROVED</td> <td>RELEASED</td> </tr> <tr> <td></td> <td>SEV</td> <td>EW/TN</td> <td></td> <td></td> <td></td> </tr> </table>	SURVEYED	DESIGNED	DRAWN	CHECKED	APPROVED	RELEASED		SEV	EW/TN				<p>ALTERNATE BID NO. 1 SG4/M REPAIR PLAN</p> <table border="1" style="width:100%; border-collapse: collapse;"> <tr> <td>SCALE</td> <td>DRAWING NAME</td> <td>PROJECT NUMBER</td> <td>SHEET NO.</td> </tr> <tr> <td>SG4M</td> <td>SG4M</td> <td>CP241341 473-070</td> <td>17</td> </tr> </table>	SCALE	DRAWING NAME	PROJECT NUMBER	SHEET NO.	SG4M	SG4M	CP241341 473-070	17
SURVEYED	DESIGNED	DRAWN	CHECKED	APPROVED	RELEASED																				
	SEV	EW/TN																							
SCALE	DRAWING NAME	PROJECT NUMBER	SHEET NO.																						
SG4M	SG4M	CP241341 473-070	17																						

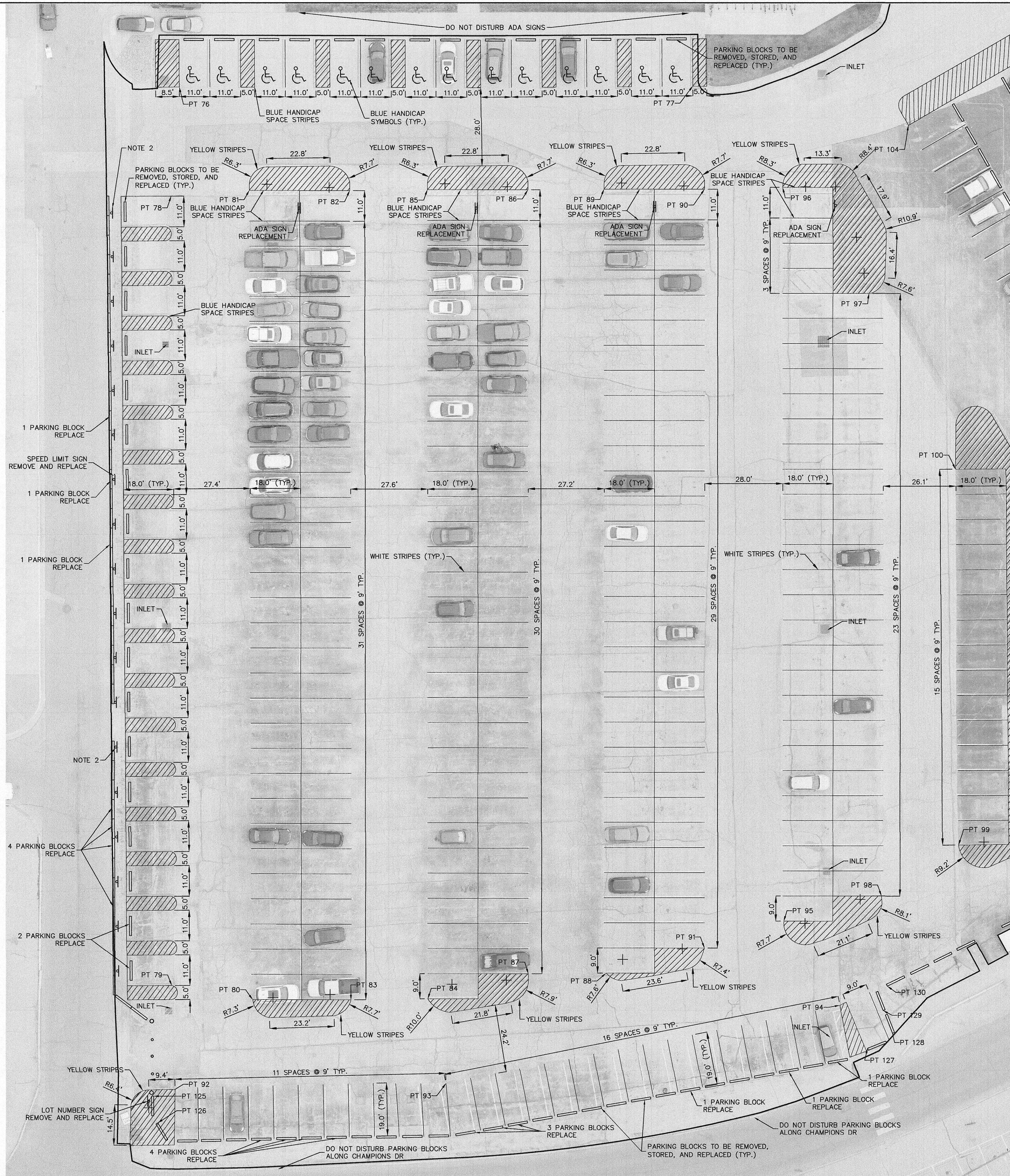

Control Point Table			
Point #	Northing	Eastings	Description
76	1128886.13	1688799.41	STRIPING
77	1128793.21	1688958.22	STRIPING
78	1128853.84	1688777.04	STRIPING
79	1128609.84	1688633.67	STRIPING
80	1128590.89	1688656.17	STRIPING
81	1128841.43	1688802.22	STRIPING
82	1128823.16	1688833.24	STRIPING
83	1128572.97	1688686.52	STRIPING
84	1128559.34	1688710.43	STRIPING
85	1128809.35	1688857.38	STRIPING
86	1128791.08	1688888.40	STRIPING
87	1128548.83	1688746.01	STRIPING
88	1128534.90	1688770.15	STRIPING
89	1128777.45	1688912.03	STRIPING
90	1128759.18	1688943.05	STRIPING
91	1128524.74	1688805.14	STRIPING
92	1128577.25	1688615.84	STRIPING
93	1128529.96	1688700.62	STRIPING
94	1128482.50	1688836.57	STRIPING
95	1128518.60	1688834.57	STRIPING
96	1128745.53	1688967.55	STRIPING
97	1128697.12	1688974.87	STRIPING
98	1128508.60	1688869.29	STRIPING
99	1128510.44	1688902.27	STRIPING
100	1128627.08	1688969.76	STRIPING
101	1128585.60	1688991.47	STRIPING
102	1128504.71	1688990.71	STRIPING
103	1128497.93	1689014.39	STRIPING
104	1128741.91	1689016.59	STRIPING
125	1128578.98	1688607.98	PARKING BLOCK
126	1128570.01	1688604.41	PARKING BLOCK
127	1128464.13	1688837.36	PARKING BLOCK
128	1128464.30	1688847.79	PARKING BLOCK
129	1128473.03	1688848.97	PARKING BLOCK
130	1128479.79	1688854.67	PARKING BLOCK

NOTES:

- CONTRACTOR SHALL REVIEW SHEET NO. 14 FOR STRIPING DETAILS.
- CONTRACTOR SHALL REMOVE EXISTING ADA SIGNS AND REPLACE WITH NEW POLES AND SIGNS.

NOTES TO THE CONTRACTOR:

Underground facilities, structures, and utilities have been plotted from available surveys and records and therefore, their locations must be considered approximate only. There may be others, the existence of which is at present not known. Verification of the locations of underground utilities, shown or not shown, will be the responsibility of the construction contractor. The contractor shall make suitable and timely requests to all utility owners, pipeline owners, or other parties affected to have all necessary adjustments of public or private utilities, pipe lines, or other appurtenances within, or adjacent to the limits of construction, as soon as practical or possible.

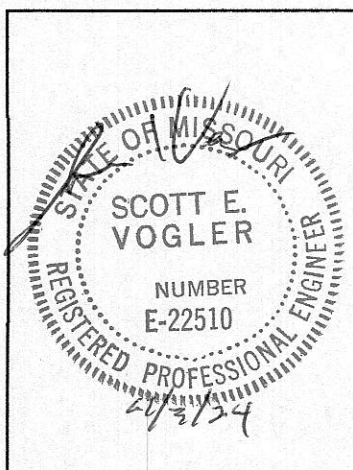

ADDENDUM NO. 1
BID SET ISSUED: 03/25/2024

NO.	DATE	REVISION DESCRIPTION	BY

IF THIS DRAWING IS PLOTTED LESS THAN 24x36 IN SIZE, IT IS A REDUCED PLOT - SCALE SHOULD BE ADJUSTED ACCORDINGLY.

OFFICE LOCATIONS
 HANBILIN, MO
 JEFFERSON CITY, MO
 BRANSON, MO
 BOONVILLE, MO
 PITTSFIELD, IL

mecoengineering.com
 MO Engineering Lic. #000898 - IL Design Firm #184-001749

THE PROFESSIONAL WHOSE SIGNATURE AND PERSONAL SEAL APPEARS ON THIS SHEET ASSUMES RESPONSIBILITY ONLY FOR WHAT APPEARS ON THIS PAGE, AND DISCLAIMS (PURSUANT TO SECTION 327.411 RSMO) & (PURSUANT TO 225 ILCS 325/PROFESSIONAL ENGINEERING PRACTICE ACT OF 1989) ANY RESPONSIBILITY FOR ALL OTHER PLANS, SPECIFICATIONS, ESTIMATES, REPORTS, OR OTHER DOCUMENTS OR INSTRUMENTS NOT SEALED BY THE UNDERSIGNED PROFESSIONAL RELATING TO OR INTENDED TO BE USED FOR ANY PART, OR PARTS OF THE PROJECT TO WHICH THIS PAGE REFERS.

VARIOUS LOCATIONS
FY24 SUMMER PAVING PROJECT - ASPHALT
UNIVERSITY OF MISSOURI PROJECT NO. CP241341

SURVEYED	DESIGNED	DRAWN	CHECKED	APPROVED	RELEASED
	SEV	EW/TN			

ALTERNATE BID NO. 1
SG4/M STRIPING PLAN

SCALE	DRAWING NAME	PROJECT NUMBER	SHEET NO.
	SG4M	CP241341 473-070	18

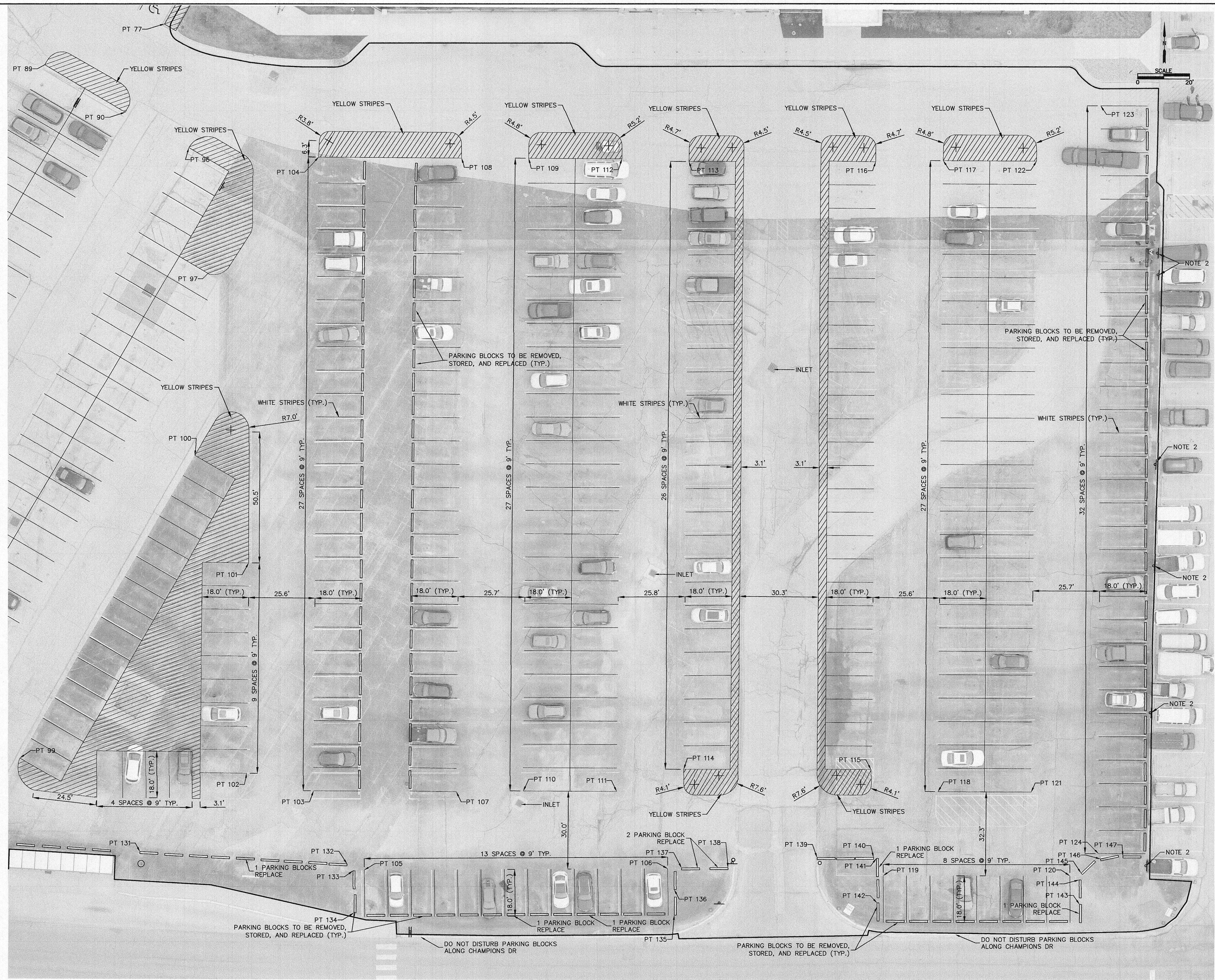

Control Point Table			
Point #	Northing	Easting	Description
105	1128467.41	1689034.99	STRIPING
106	1128467.92	1689151.99	STRIPING
107	1128497.60	1689070.47	STRIPING
108	1128741.54	1689072.73	STRIPING
109	1128741.47	1689098.52	STRIPING
110	1128497.86	1689096.24	STRIPING
111	1128497.67	1689132.24	STRIPING
112	1128741.26	1689134.52	STRIPING
113	1128740.19	1689160.36	STRIPING
114	1128506.18	1689158.21	STRIPING
115	1128506.04	1689230.48	STRIPING
116	1128740.06	1689232.40	STRIPING
117	1128740.49	1689258.42	STRIPING
118	1128497.50	1689256.15	STRIPING
119	1128465.18	1689235.12	STRIPING
120	1128465.07	1689307.12	STRIPING
121	1128497.31	1689292.15	STRIPING
122	1128740.30	1689294.41	STRIPING
123	1128761.61	1689319.27	STRIPING
124	1128473.61	1689318.18	STRIPING
131	1128474.49	1688948.47	PARKING BLOCK
132	1128469.76	1689028.40	PARKING BLOCK
133	1128467.14	1689030.68	PARKING BLOCK
134	1128450.91	1689030.96	PARKING BLOCK
135	1128450.00	1689154.45	PARKING BLOCK
136	1128459.89	1689154.43	PARKING BLOCK
137	1128468.19	1689157.35	PARKING BLOCK
138	1128468.29	1689175.23	PARKING BLOCK
139	1128472.16	1689209.63	PARKING BLOCK
140	1128472.21	1689231.41	PARKING BLOCK
141	1128471.83	1689232.51	PARKING BLOCK
142	1128454.67	1689232.65	PARKING BLOCK
143	1128454.04	1689310.76	PARKING BLOCK
144	1128463.55	1689310.68	PARKING BLOCK
145	1128466.13	1689311.45	PARKING BLOCK
146	1128471.55	1689318.95	PARKING BLOCK
147	1128472.68	1689327.59	PARKING BLOCK

- NOTES:**
- CONTRACTOR SHALL REVIEW SHEET NO. 14 FOR STRIPING DETAILS WITHIN THE LIMITS ON THIS LOT.
 - PARKING SIGNS FROM ADJACENT LOT IN PROJECT AREA SHALL BE REMOVED, STORED, AND REPLACED.

NOTES TO THE CONTRACTOR:

Underground facilities, structures, and utilities have been plotted from available surveys and records and therefore, their locations must be considered approximate only. There may be others, the existence of which is at present not known. Verification of the locations of underground utilities, shown or not shown, will be the responsibility of the construction contractor. The contractor shall make suitable and timely requests to all utility owners, pipeline owners, or other parties affected to have all necessary adjustments of public or private utilities, pipe lines, or other appurtenances within, or adjacent to the limits of construction, as soon as practical or possible.

ADDENDUM NO. 1
BID SET ISSUED: 03/25/2024

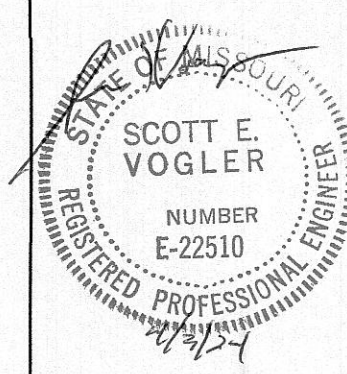

NO.	DATE	REVISION DESCRIPTION	BY

MECO
ENGINEERING CO., INC.

OFFICE LOCATIONS
HANNIBAL, MO
JEFFERSON CITY, MO
BRANSON, MO
BOONVILLE, IL
PITTSFIELD, IL

mecoengineering.com
MO Engineering Lic. #000898 - IL Design Firm #184-001749

THE PROFESSIONAL WHOSE SIGNATURE AND PERSONAL SEAL APPEARS ON THIS SHEET ASSUMES RESPONSIBILITY ONLY FOR WHAT APPEARS ON THIS PAGE, AND DISCLAIMS (PURSUANT TO SECTION 327.411 RSMO) & (PURSUANT TO 225 ILCS 325/PROFESSIONAL ENGINEERING PRACTICE ACT OF 1989) ANY RESPONSIBILITY FOR ALL OTHER PLANS, SPECIFICATIONS, ESTIMATES, REPORTS, OR OTHER DOCUMENTS OR INSTRUMENTS NOT SEALED BY THE UNDERSIGNED PROFESSIONAL RELATING TO OR INTENDED TO BE USED FOR ANY PART, OR PARTS OF THE PROJECT TO WHICH THIS PAGE REFERS.

VARIOUS LOCATIONS
FY24 SUMMER PAVING PROJECT - ASPHALT
UNIVERSITY OF MISSOURI PROJECT NO. CP241341

SURVEYED	DESIGNED	DRAWN	CHECKED	APPROVED	RELEASED
	SEV	EW/TN			

ALTERNATE BID NO. 1
SG4/M STRIPING PLAN

SCALE	DRAWING NAME	PROJECT NUMBER	SHEET NO.
	SG4M	CP241341 473-070	19

L:\MO-Projects\CP241341\MOE-2024-Summer Paving - Design\DRAWINGS\SUBMITTALS\PACKAGES\SG4M.dwg, SCALE: STRIPING, 03/25/2024, 2:16:31 PM